



JEVONS DRIVE

EXISTING JOHN BODDY RESIDENTIAL

LEGEND

- 24.61' (7.5m) Semis
- 29.53' (9.0m) Singles
- 34.12' (10.4m) Singles
- 39.37' (12.0m) Singles
- 39.37' (12.0m) Singles (Corner Lots)
- Existing Residential

SHARPLIN DRIVE

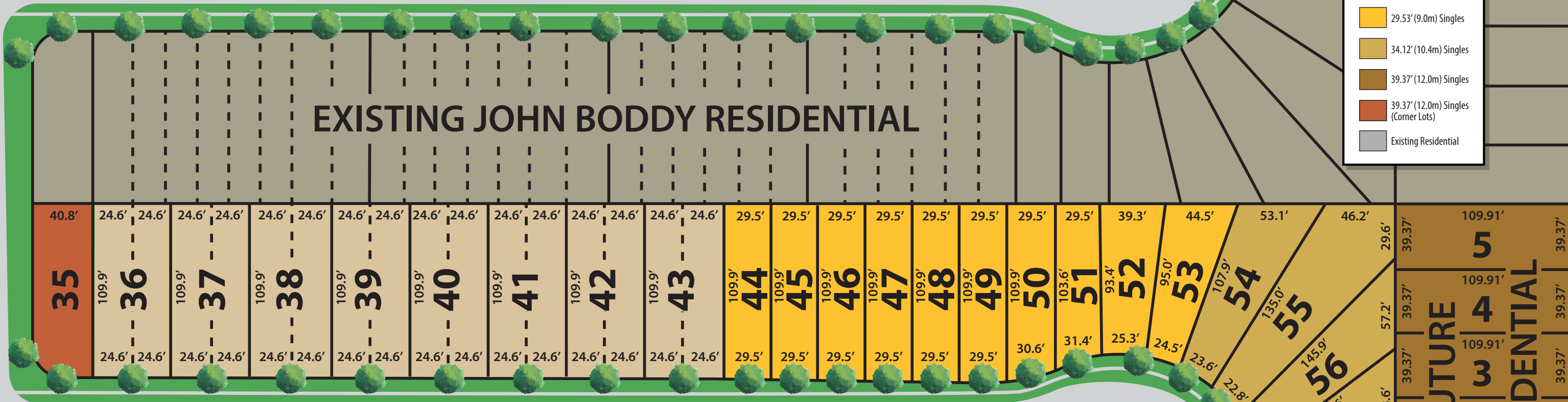

MCMEEKIN DRIVE

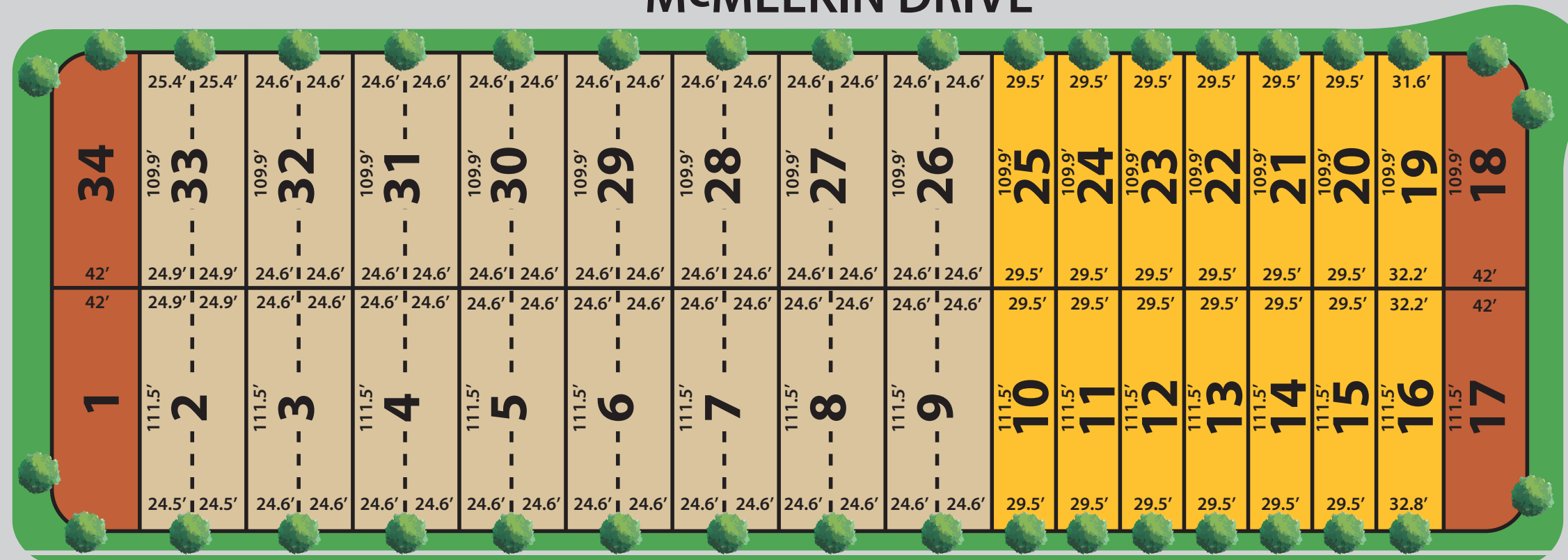

DENNY STREET

Any inquiries dealing with the proposed engineering design, lot grading, utility locations or general construction can be directed to Town of Ajax Engineering Section at 905-619-2529 ext 3251. All plans and dimensions are approximate and subject to change at the discretion of the Vendor and final Town approval. All renderings are artist concept only. All measurements are imperial, E. & O.E.